

Radius Payment Solutions, Crewe

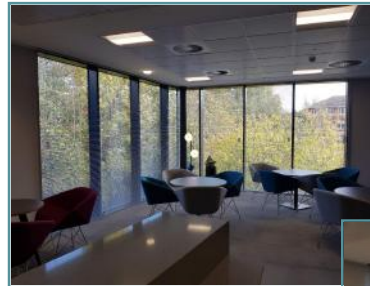

Front Elevation



Internal Office View

Project

The 4 storey, 66,000sq ft multi million pound project at Admiral Court Crewe, Cheshire is to become the new global HQ for Radius Payment Solutions to improve capacity from its existing facility at Herald Park in Crewe.

In addition to the office areas the building will also include communal meeting areas, a café and gym.

Solution

Pentel were originally supplied with a detailed specification from the Contractor for the new site at Admiral Court in Crewe.

Following a site meeting with both the Contractor and Client, it was agreed that the same look and functionality as the blinds already installed at the Client's Herald Park site was the preferred option. Pentel were therefore tasked with supplying and installing 35mm non-standard venetian blinds throughout. Colour swatches were provided to ensure an exact colour match was also achieved.

Benefits

- Effective glare control to provide a comfortable environment.
- A simple and effective cord system to adjust the angle of the slats and also raise and lower the blind to control the level of light coming into the building.
- Simple, effective and robust system.

Details

Products:	Astralux 2000 Venetian Blind System
	35mm Slats
	Manual Operation
Architect:	AEW Architects
Contractor:	Overbury PLC
Client:	Radius Payment Solutions

Please contact us for more reference sites or any further information